



Inflatable Lounger Manual Instruction

WARNING !

- This is not a lifesaving device.
- Do not leave child unattended while in use.
- Use only under competent adult supervision.
- Keep away from source of heat.
- Keep away from sharp objects.
- Do not over inflate or use high pressure to inflate.

Assembly instructions:

1. Spreading the product and find out the pump & Valve opening on the back of the item.
Make sure the valve is closed before starting the pump.(see Fig .1 & Fig.2 below)
2. Use air pump (included) to inflate the lounger. When the air is pumped to 1/3 saturation, adjust the position of the inflatable lounger to make more closely fit the cloth cover. Then refill air.
3. Note that the lid of the air nozzle shall be grasped during air pumping to ensure that the position of the air nozzle is kept at the opening position of the cloth sleeve without deviation.

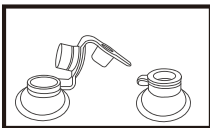

Fig.1

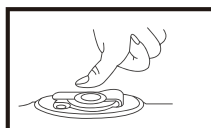

Fig.2

CLEANING AND MAINTENANCE:

- Do not wring during washing. Wash with general synthetic detergent.
- Dry in shade, do not tumble drying.

NOTE:

- It's easier to install this product by 2 persons.
- Because of the air tightness of PVC, the product may become softer after using.
You are asked to refill air after each use.

VINYL PLASTIC REPAIR KIT INSTRUCTIONS:

Note: This vinyl is temporary use when hole or puncture is less than 1mm)

1. Cut a piece of vinyl large enough to cover the hole or puncture.
2. Thoroughly clean damaged surface and allow to dry for a minimum of 10 minutes.
3. Remove vinyl patch from paper backing.
4. Press patch firmly over hole or puncture.
5. Do not inflate after 20 minutes repair.
6. Please keep the repair kit and instruction for any chance may use.

PVC SHEET REPAIR KIT INSTRUCTIONS:

Note: Suggest to repair the hole or puncture with PVC when it is larger than 1mm

1. Cut a piece of PVC large enough to cover the hole or puncture.
2. Thoroughly clean damaged surface and allow to dry for a minimum of 10 minutes.
3. Apply glue on the PVC sheet and around the hole or puncture location.
(NOTE: GLUE NOT INCLUDED, Suggest glue style: Liquid Vinyl / PVC / Cement Glue).
4. Press patch firmly over hole or puncture.
5. Do not inflate after 20 minutes repair.
6. Please keep the repair kit and instruction for any chance may use.

Parts Include:



Or



Inflatable x 1



Cover x 1

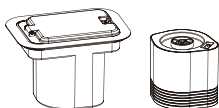

Build-in Pump x 1



PVC sheet x 3



Vinyl repair kit x 2

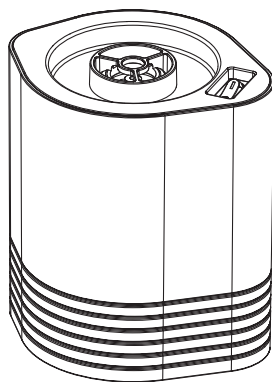
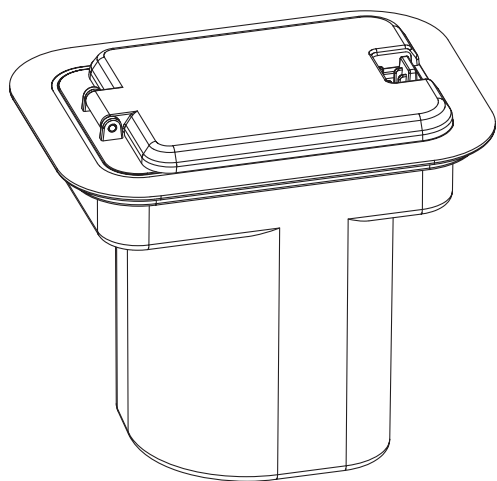

OPERATION INSTRUCTIONS

< 8512 >

TAKE PUMP OUT BEFORE ENTERING THE WATER

- Thank you for purchasing this product.
- In order to use this product properly, please read this instruction before using it.
- Please keep this manual in a place where you can find easily after reading.

CONTENT

Specification

Warning

Function description

Basic using instructions.....

Specification

Voltage	DC 3.7V	USB Type-C Input	DC 5V, Suitable for 5V/1A、 5V/2V、 5V/3A charger
Current	15A Standby Current<20UA		
Working noise	≤86dB	Weight	0.68kg
Product size	16.2*11.7*13.6cm	Bubble bag size	18*16*0.05cm
Battery specification	18650 2500mAh 9.25WH 10C		
Product power	DC 3V-28000RPM-2500mAh		
Air pressure	Above 80% battery ≥3800 Pa, Full battery ≥4200Pa		
Accessories	Nozzles, USB cable, Instruction Manual, Air pump		
This inflatable air pump is a built-in pump, please use it with corresponding inflatable products.			



Warm Tips

To ensure normal use of product, please strictly follow the user manual for using

Warnings



- Do not place/stock the pump in wet or liquid condition .



- Never look inside or point the blowhole towards your eyes when the pump is working.



- The operator should be around when the pump is plug in.
- Please stop using the air pump at once if there are sands, small stones etc. to be sucked into inflation/deflation port.
- Please do not use any accessories not provided by this product.
- Please unplug it immediately if there is anything wrong during usage.
- Children must be under supervision by adult to use this product.
- Please turn off the power supply before cleaning or after using every time.



- Please do not disassemble the power supply by yourself if it is damaged. It must be replaced by the manufacturer or other professional people.

Function description

Button

1. Turn on the switch, motor starts working.
Turn off the switch, motor stops working.
2. The motor will automatically shut down after continuous working for 5 minutes, if you want to start motor again, you need to turn off the switch first, then turn on the switch.

Indicator light

1. Turn on the switch, motor starts working ;
2. When the battery voltage under $3V \pm 0.1V$, red light will blink;
3. When the battery voltage under $2.6V \pm 0.1V$, the motor stop working, and red light off.

Charging

1. We can't turn on the switch when charging. If plug in charge while working, the motor will stop working immediately, and the pump will be in charging state;
2. Red light on if not full charge;
3. Green light on if full charge.

Attention:

1. The operating time for the air pump must not exceed 5 minutes per start, cold for 10 minutes before next work;
2. Charge time is at least 4 hours, don't charge over 12 hours for every charging;
3. Do not heat and burn the battery;
4. Do not disassemble and squeeze the product;
5. Do not charge under high temperature, such as don't close by the fire;
6. Please charge in time when red light is blinking;
7. Do not wet the product or put it into water;
8. Put the product with ambient temperature under 30°C if the product needs to be stored for a long time;
9. Please charge it in time if the product is placed for more than half a year;
10. After the product is stored for a long time, you need to charge and discharge it several times to recover the battery capacity;
11. The product is not suitable for Children or weakling, unless they are fully supervised by person in charge to ensure safety using.

Basic using instructions

1. The inner pump is used with nozzles;
2. Press "-" to power on, and press "o" to power off;
3. Installing the pump into the outer shell to work.

Working instructions as outer pump

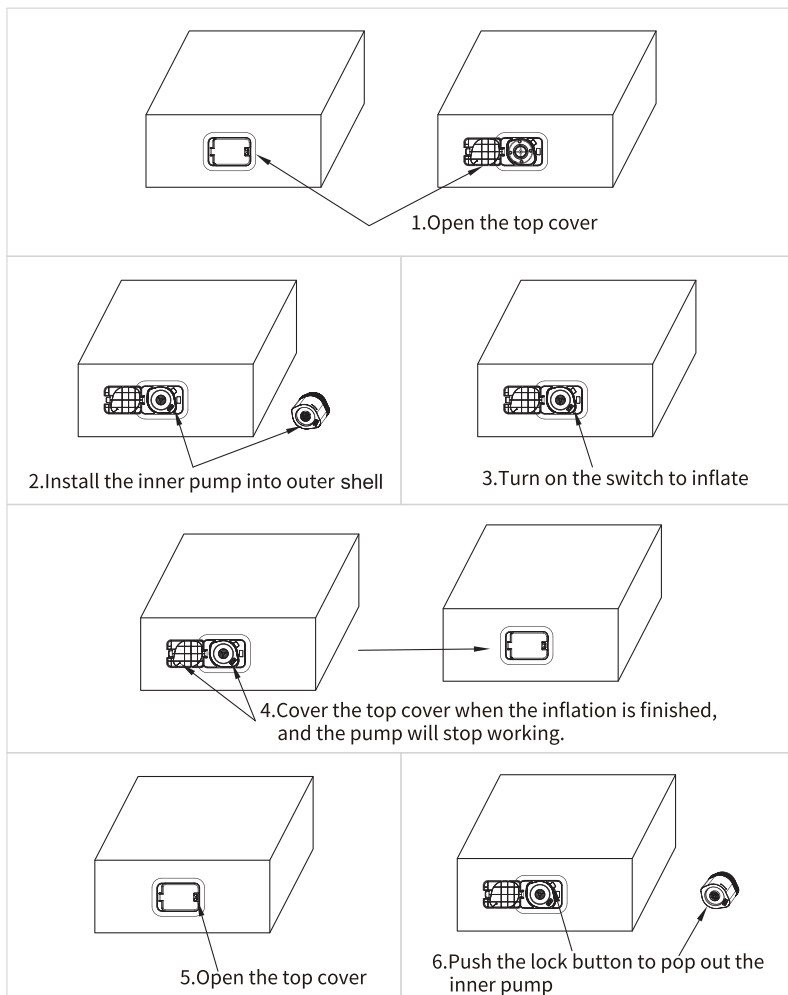

Working instructions as inner pump

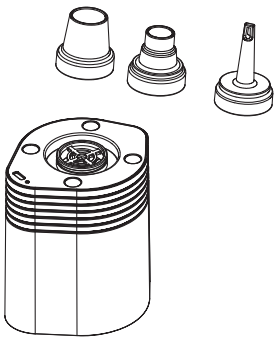

· Connect the nozzles to bottom cover air outlet to inflate stuff.



· Connect the nozzles to top cover air inlet to deflate stuff.

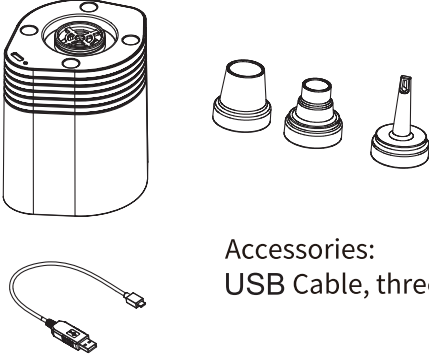

Accessories:
USB Cable, three nozzles

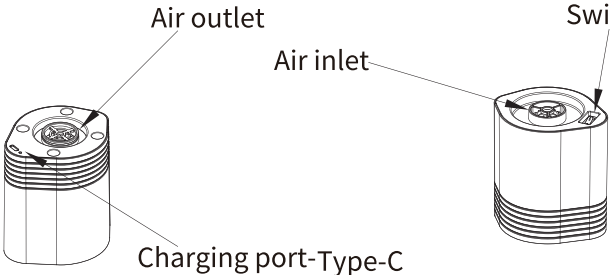

Air outlet
Air inlet
Charging port-Type-C
Switch